

**5th Annual
Indiana University School of Medicine
Education Day Program**

Hine Hall Conference Center

**Friday, April 26th, 2024
8:00 am – 5:00 pm**

“Intelligent Medical Education using AI”



INDIANA UNIVERSITY
SCHOOL OF MEDICINE

9:00 – 9:05 AM: WELCOME FROM DEAN WALLACH



Paul M. Wallach, MD

*Executive Associate Dean, Educational Affairs
Indiana University School of Medicine*

Paul M. Wallach, MD, a national leader in academic medicine and a proponent of educational innovation, joined IU School of Medicine in 2018. He is a general internist who completed medical school and residency at the University of South Florida College of Medicine. Since arriving at IUSM, Wallach has focused on introducing point of care ultrasound to our educational program and enhancing our 9-campus model through the creation of a scholarly concentrations. The 1st annual Education Day for IUSM was introduced in 2020 to highlight education as a core mission and to showcase the important work by many at our school.

12:00 – 12:45 PM: KEYNOTE SPEAKER



Hooman H. Rashidi MD, MS, FCAP

*Associate Dean of AI in Medicine
University of Pittsburgh School of Medicine
Professor & Endowed Chair of Lombardi-Shinozuka Experimental Pathology
Research
Executive Vice Chair of Computational Pathology
Executive Director of CPACE (Computational Pathology & Ai Center of
Excellence)*

“Reshaping the Future of Medical Care, Education and Research: The Pivotal Roles of Synthetic Data, Generative AI, and Auto-MLs”

Dr. Rashidi is a physician scientist, inventor of several well established and validated Data Science Apps/ Machine learning Platforms (e.g. MILO Auto-ML, MILO APT, STNG, etc.) and a prolific author. He is currently the Associate Dean of AI in Medicine at the University of Pittsburgh school of medicine, Professor & Endowed Chair of Experimental Pathology Research, Executive Vice Chair of Computational Pathology and the Executive Director of CPACE (Computational Pathology & AI Center of Excellence, a joint venture of U Pitt and UPMC). In light of his extensive background and experience in the machine learning and bioinformatics domains, he continues to create innovative new tools and resources that improve clinical practice, research, and education.

Dr. Rashidi is also a committed educator with numerous teaching awards and well established medical educational Apps. His efforts in the AI-ML & digital space are internationally recognized, as evidenced by his active numerous invited talks (at numerous prestigious institutions and conferences), his various editorial & reviewer roles in this domain, his numerous published key invited review articles & his continued national committee roles within this space.

5th IUSM Education Day Agenda In-Person Event @ Hine Hall, IUPUI Campus Friday, April 26, 2024		
8:00-9:00 am	Hine Hall Slate Foyer	Registration
9:00-9:05 am	Hine Hall Auditorium	Welcome from Paul Wallach, MD – Executive Associate Dean Educational Affairs, IUSM
9:05-9:50 am	Hine Hall Auditorium	1 st Selected Oral Presentations
9:50-10:00 am		Break
10:00-10:45 am	Hine Hall Auditorium	2 nd Selected Oral Presentations
10:45-11:00 am		Break
11:00-11:45 am	Hine Hall (HH)	Concurrent Small Group Discussions and Workshops (HH- 216, 219, 232)
11:45-12:00 pm		Break
12:00-12:45 pm	University Tower Ballroom	Lunch and Keynote Speaker (<i>Hooman H. Rashidi, MD, MS, FCAP</i>)
12:45-1:00 pm		Break
1:00-1:45 pm	Hine Hall (HH) / University Tower (UT)	1st Concurrent Themed Oral Presentations: <ul style="list-style-type: none"> ▪ Diversity, Equity, Inclusion & Justice (UT- Presidents Room) ▪ Wellness (UT- Purdue Room) ▪ Simulation (HH- 226) ▪ Point of Care Ultrasound (UT- Indiana Room) ▪ Resident Patient Safety – I (HH- 219)
1:45-2:00 pm		Break
2:00-2:45 pm	Hine Hall (HH) / University Tower (UT)	2nd Concurrent Themed Oral Presentations <ul style="list-style-type: none"> ▪ Regional Medical Campuses (UT- Indiana Room) ▪ Undergraduate Medical Education (UT- Purdue Room) ▪ Graduate Medical Education (UT- Presidents Room) ▪ Resident Patient Safety – II (HH- 219) ▪ Simulation Center Collaboration Group (HH- 232)
2:45-3:00 pm		Break
3:00-4:00 pm	Hine Hall Hallway	Poster Presentations (1 st and 2 nd floor) Scholarly Concentration Poster Presentations (2 nd floor)
4:00-5:00 pm	Hine Hall Auditorium Lobby	Reception and Certificates

9:05 - 9:50 AM: 1st SELECTED ORAL PLATFORM PRESENTATIONS

[Auditorium]

1. **A Program Weighted Situational Judgement Test as an Adjunct for Holistic Medical Student Application Review**
Krusing, Madeline; Nickel, Brianne; Miller, Payton; Hunt, Maya; Stefanidis, Dimitrios; Ritter, E. Matthew
2. **BIG Interview Medical Prepared Students for Virtual Interviewing**
Rusk, Debra; Holt, Ashley; Dawes, Avery; Christman, Megan; Walvoord, Emily; Shanks, Anthony
3. **Compensation and Popularity of Internal Medicine Subspecialties**
Pfeifle, Daniel; Pollak, Micah; Bosslet, Gabriel
4. **Comparison of Executive Functions between Categorical and Preliminary General Surgery Interns**
Anton, Nicholas; Miller, Payton; Hunt, Maya; Krusing, Madeline; Doster, Dominique; Ritter, E. Matthew; Choi, Jennifer; Stefanidis, Dimitrios

9:50 – 10:00 AM: BREAK

10:00 – 10:45 AM: 2nd SELECTED ORAL PLATFORM PRESENTATIONS

[Auditorium]

1. **Residents, Interrupted: A Blinded, Prospective Observational Study of Resident**
Nussbaum, Kayla; Turner, Joe; Hays, Matt; Morales, Adrian; Li, Xiaochun; Maudlin, Jill; Pettit, Katie
2. **Health Equity Curricular Innovation for Obstetrics and Gynecology Clerkship**
Chimhanda, Maryann; Kirksey, Makayla; Chartier, Katherine; Thomas, Allyson; Shanks, Anthony
3. **The Impact of Service Learning on Medical Students' Professional Development**
Messmore, Niki; Earhart, Lauren; Gunderman, David; Rusk, Debra; Eron, David; Wojciechowska, Klaudia
4. **Dissecting the Dissectors: A Comparative Analysis of Post-Dissection Reflections by Students and AI**
Becker, Robert; Robertson, Kyle; Byram, Jessica

10:45 – 11:00 AM: BREAK

11:00 – 11:45 AM: CONCURRENT WORKSHOPS & SMALL GROUP DISCUSSIONS

HINE HALL [ROOM 219]

1. Tips to Leverage Your ORCID

Dolan, Levi; Ramirez, Mirian; Craven, Hannah; Whipple, Elizabeth

HINE HALL [ROOM 232]

1. Medical Students Want Asynchronous Content. But Do They Watch It?

Stanton-Maxey, Katie; Mossler, Lindsey; Imeokparia, Sade; Rendina, Megan; Krupa, Cassey; Skiles, Anne; King, Justin; Gutwein, Ashley; Zborek, Kirsten; Loria, Chelsea; Geib, Merideth

HINE HALL [ROOM 216]

1. Creation of a USMLE Step 2 Prediction Model for IUSM Students

Steckler, Ben; Smith, Sarah; Rusk, Debra; Shanks, Anthony; Dajoe, Erin; Wallach, Paul; Walvoord, Emily

11:45 – 12:00 PM: BREAK

12:00 – 12:45 PM: KEYNOTE SPEAKER & LUNCH [UNIVERSITY TOWER BALLROOM]

12:45 – 1:00 PM: BREAK

1:00 – 1:45 PM: 1st CONCURRENT THEMED ORAL PRESENTATIONS

DIVERSITY, EQUITY, INCLUSION, AND JUSTICE

[University Tower - Presidents Room]

Session Leader: *Matthew Holley, PhD*

Additional Contributors:

1. **Physician Advocacy and IUSM's HEAL Competency: A Comparative Analysis**
Mansoori, Afsheen; Popoola, Ovesola; Blodgett, Alison; Schantz, Eli
2. **Addressing Disparities in Skin Cancer through a Primary Care-Focused Educational Intervention**
Watters, Jennifer; Bell, Maria; Slaven, James; Que, Syril Keena

WELLNESS

[University Tower - Purdue Room]

Session Leader: Heather Kelker, MD

SIMULATION

[Hine Hall 226]

Session Leader: Dylan Cooper, MD

Additional Contributors:

- 1. Medical Students as Innovators: The Design and Feasibility Assessment of a Novel Prototype Closed-Loop Oxygen Flow Control Device Using Simulation and Physiological Modeling**
Duggan, Ben; Wilson, Damen; Earl, Conner; Libke, Megan; Sivaprakasam, Andrew
- 2. Mental Skills Use Associated with Decreased Stress in Simulated Intraoperative Scenarios**
Hunt, Maya; Anton, Nicholas; Mitchell, Sally; Thomas, Christopher; Li, Wendy; Cartwright, Johnny; Kalantar Motamedi, Seyed Mohammad; Stefanidis, Dimitrios
- 3. Mastery Procedural Education**
Moore, Malia

POINT OF CARE ULTRASOUND – PoCUS

[University Tower – Indiana Room]

Session Leader: Rob Ferre, MD

Additional Contributors:

- 1. Point-of-care Ultrasound Utilization by Emergency Medicine Physicians is Improved with a Training and Credentialing Program**
Brenner, Daniel; Frey, Drew; Singh, Harpriya; Kennedy, Sarah; Russell, Frances; Ferre, Robinson
- 2. PGY-1 Point-of-Care Ultrasound Integration: A Structured Curriculum for IM Residents**
Doyle, Jesse; Bachar, Roudi; Butler, James
- 3. PNEU Opportunities for Resident POCUS Curriculum Development: A Targeted Needs Assessment**
Miller, Payton; Hunt, Maya; Krusing, Madeline; Ritter, E. Matthew; Stefanidis, Dimitrios; McDow, Alexandria
- 4. Point of Care Ultrasound Training with Musculoskeletal Evaluation Uptake at Rural Clinics**
Tollar, Roarke; Smeltzer, Kathryn; Cook, Myanna; Wilcox, James; Ireland, Ellen

RESIDENT PATIENT SAFETY - I

[Hine Hall - 219]

Session Leaders: Jessica Adams, MD; Mahrosh Ahmed, MD; Piiamaria Virtanen, MD; Tina Marie Schade Willis, MD

Additional Contributors:

- 1. Careers in Quality Improvement**
Schade Willis, Tina M.
- 2. A Plan to Promote High Quality Colorectal Screening in Patients with Cystic Fibrosis**
Goble, Gretchen
- 3. Resident Education in the Care of Limited English Proficiency Patients in Primary Care**
Shofner, Rebecca
- 4. Behaviors and Barriers Regarding Home Blood Pressure Monitoring in a Safety Net Health System Clinic**
Warren, Kyle
- 5. Optimizing Hypertension Management in the Veterans' Administration (VA) Green Clinic**
Shi, Justin

1:45 – 2:00 PM: BREAK

2:00 – 2:45 PM: 2nd CONCURRENT THEMED ORAL PRESENTATIONS

REGIONAL MEDICAL CAMPUSES

[University Tower - Indiana Room]

Session Leader: Elizabeth Ryan, EdD

Additional Contributors:

1. **Assessing a Longitudinal Educational Experience for Continuous Quality Improvement**
Birnbaum, Deborah; Masseria, Anthony; Walsh, Sarah
2. **Strategies and Challenges to Diversifying the Standardized Patients at a Rural Regional Campus**
Menez, Olwen; Zagales, Ruth; Colleton, Taylor; Rodriguez Arte, Claudia; Cordero, Laura

UNDERGRADUATE MEDICAL EDUCATION

[University Tower – Purdue Room]

Session Leader: Bradley Allen, MD

Additional Contributors:

1. **Development of Phase 1 Remediation Program**
Byram, Jessica and Kaminske, Althea
2. **Introduction to the Laboratory and Blood Bank: Creation of a Resource for Third-Year Medical Students**
Merritt, Emily; Harmon, Joseph; Lavik, John-Paul

GRADUATE MEDICAL EDUCATION

[University Tower - Presidents Room]

Session Leader: Christen Dilly, MD

Additional Contributors:

1. **The Foundational Surgical Resident: A Test Development Approach to Competency-Based Education in General Surgery**
Hunt, Maya; Miller, Payton; Yan, Yichuan; Krusing, Madeline; Li, Wendy; Thomas, Christopher; Doster, Dominique; Stefanidis, Dimitrios; Choi, Jennifer; Ritter, E Matthew
2. **Staying Put or Moving Out? Analyzing Post-Residency Decisions of Family Medicine Physicians in Indiana: A 12-Year Survey Study**
Ho, Monling; Potter, Maddie; Kochhar, Komal; Wallach, Paul
3. **A Needs Assessment of Educational Needs Among Surgical Educators and Trainees: A Mixed-Methods Study**
Krusing, Madeline; Yan, Yichuan; Hunt, Maya; Awad, Michael; Stefanidis, Dimitrios
4. **Multimodality, Online Oncology Learning Curriculum: An Adaptable, Asynchronous Learning Resource**
Pham, Phillip; Dandu, Vidya; Schwartz, Jennifer; King, Jennifer

RESIDENT PATIENT SAFETY - II

[Hine Hall - 219]

Session Leaders: Jessica Adams, MD; Mahrosh Ahmed, MD; Piiamaria Virtanen, MD; Tina Schade Willis, MD

Additional Contributors:

1. **Minimizing Surgical Site Infections in Elective Cranial Surgery**
Budnick, Hailey
2. **Disparities in Restraint Use in the Neurocritical Care Unit**
Virtanen, Piiamaria
3. **We're PreP-ED! – Initiating HIV Pre-Exposure Prophylaxis in the Emergency Department**
Ragusa, Anthony
4. **Not So BRIEF: Executive Dysfunction Persists Throughout Residency Training**
Miller, Payton; Anton, Nicholas; Doster, Dominique; Choi, Jennifer; Stefanidis, Dimitrios; Ritter, E. Matthew

SIMULATION CENTER COLLABORATION GROUP

[Hine Hall 232]

Session Leader: Dylan Cooper, MD

2:45 – 3:00 PM: BREAK

3:00 – 4:00 PM: POSTER PRESENTATIONS

[1st & 2nd Floor Hallway]

1. Diversity, Equity, Inclusion, and Dress Codes in Medical Education: A Preliminary Report

Gatz, Allison; Pauly, Alexandra; Russell, Carl; Andrews, Madeline; Chen, Jenny; Ahmad, Kamran; Schantz, Eli

2. How Girls STEM Institute Impacts Black Girls' Interest in STEM Careers

Olumba, Chinonye; Morton, Crystal Hill; Messmore, Niki

3. Finding an LGBTQIA+ Culture Fit: Analyzing Midwest Internal Medicine Residency Program Websites for Non-discrimination and Inclusion Content

Gribbin, William; Baker, Brittany; Peterson, Ellen; Anak Ganeng, Brenda; Byram, Jessica

4. Positive and Adverse Childhood Experiences in Medical Trainees

Byram, Jessica; Kopstick, Avi; Agosto, Elizabeth; Ali, Minaal; Mercado, Anjali; Arenson, Michael

5. One is Too Many: Suicidality in General Surgery Residency

Nasca, Brian; Hunt, Maya; Li, Ruoqia; Hu, Andrew; Agarwal, Gaurava; Eng, Joshua; Bilimoria, Karl; Hu, Yue-Yung

6. Co-Development and Testing of a Culturally Tailored Telehealth Mental Health Intervention

Khan, Nida; Connors, Jill Nault; Magalhaes, Ernani; Prather, Kevin; Draucker, Claire; Eliacin, Johanne; Montgomery, Chet; Hayden, Julie; Millard, Michael; Musey, Paul

7. Pre-Clinical Medical Student Bias Against Mental Health and Psychiatry: Factors Affecting Improvement

Smith, Alyssa; McCann, Joseph; Quast, Laura; Bryant, Lauren; Lai, Dongbing; Plawecki, Martin

8. Bereavement Scheduling Guidelines for Emergency Medicine Residents: A Descriptive Pilot Study

Kelly, Timothy; de Venecia, Bryce; Pang, Peter; Turner, Joseph; Reed, Kyra; Pettit, Katie

9. Development of a Stressful Surgical Simulation Scenario

Anton, Nicholas; Chen, Haozhi; Hunt, Maya; Kalantar Motamedi, Seyed Mohammad; Thomas, Christopher; Mitchell, Sally; Yu, Denny; Stefanidis, Dimitrios

10. Developing a Multidisciplinary Proficiency-Based Robotics Curriculum for all Operating Room Team Members

Picklesimer Doyle, MaKayla; Moss, Kevin; Bruce, Abena; Oshinowo, Adeoti

11. The Rise of Anki: Medical Students' Utilization and Perceptions of the Popular Flashcard Application

Hoffman, Leslie

12. Faculty and Student Perceptions of Small Group Learning at IUSM

Husmann, Polly; Collett, Jason; Ott, Vivian; Majmudar-Sheth, Bittu; Richardson, Jennelle

13. Comparing Student Satisfaction Metrics: Strategic Student Survey versus Traditional Tools

Kochhar, Komal; Masseria, Anthony; Walsh, Sarah; Skillman, Brian; Dunham, Jennifer; Wallach, Paul

14. Investigating Faculty Perspectives of Opioid Education Curriculum for Medical Students

Kruskie, Megan; Byram, Jessica; Agosto, Elizabeth

15. Assessing the Use of Medical Student Board Examination Study Materials Throughout the OBGYN Clerkship

Hardman, Sara; Patrick, Elise; Chimhanda, Maryann; Shanks, Anthony

16. Students Teaching Students: Engaging in Near-Peer Teaching in Medical School

Prasad, Priyanka and Gunderman, Richard

17. Integration of Evidence Based Medicine (EBM) into a First-year Pre-clinical Undergraduate Medical Student Anatomy Course

Robertson, Kyle; Vargo-Gogola, Tracy; Byram, Jessica

18. The Success Rate of Parallel Planning for Indiana University School of Medicine Students

Holt, Ashley; Harvey, Brianna; Shanks, Anthony; Rusk, Debra

19. Formal Near Peer Teaching in the Surgery Clerkship: Implementation of a Teaching Assistant Benefits Both Teachers and Students

Stanton-Maxey, Katie; Mossler, Lindsey; Imeokparia, Sade; Rendina, Megan; Krupa, Cassey; Vyas, Punit

20. Characteristic Descriptors for Medical Students in Anesthesiology Elective Evaluations - Implications for Letters of Recommendation

Yu, Corinna; Dijak, Frank; Dammann, Erin; Guillaud, Daniel; Packiasabapathy, Senthil

21. Designing a Structured Educational Curriculum for Chest X-Ray (CXR) Interpretation

Khan, Zaraq; Poldneff, David; Chaudhary, Yafaa; Doyle, Jesse; Bachar, Roudi; Singson, Adrian

22. Telemedicine Education for OBGYN Trainees

Rouse, Caroline; Patrick, Elise; Scott, Nicole; Shanks, Anthony

23. Implementation of an Introductory Clinical Reasoning Curriculum for Pediatrics Residents: A Pilot Study

Perry, Kelsey; Warren, Kyle; Wilson, Michael

24. A Roadmap to Surgical Education: A Scoping Review of Educational Needs in Surgery

Yan, Yichuan; Krusing, Madeline; Stefanidis, Dimitrios

25. Analyzing Linguistic Dimensions of AI and Medical Students Professional Identity Reflections

Byram, Jessica; Frankel, Richard; Isaacson, Harry; Mehta, Neil

26. What Kind of AI User Are You?

Dolan, Levi; Jones-VanMieghem, Cassandra; Papandreou, Amanda

27. Adoption and Attitudes of AI Large Language Models in Academic Settings and Beyond

Gomez, Victoria; Balle, Megan; McNulty, Margaret

28. Ethical Boundaries in AI-Driven Medical Education: Safeguarding Patient Data

Karki S; Stephanian B; Schantz EG

29. Advancing AI in Medical Education: Understanding the Malpractice Landscape

Stephanian B; Karki S; Schantz EG

30. Use of Artificial Intelligence Program to Increase Resident Confidence and POCUS Use at the Bedside

Wilcox, James; Lobo, Daniela; Renshaw, Scott; Holley, Matt; Hernandez, Ruben

31. Successful Faculty Development Via Behavioral Economics and Effective Use of Nudges

Boyer, Tanna, Ye, Jian; Mitchell, Sally

32. Faculty Learning Communities: A Collaborative Model for Professional Development of Medical Educators in our Multi-Campus System, 2019 to Present

Kochhar, Komal; Longtin, Krista; Wilson, Shawn; Ho, Monling; Hobson, Tara; Holley, Matthew; Brokaw, James; Wallach, Paul

33. Statewide Synergy: Showcasing Scholarship and Innovation in Medical Education at IUSM, 2020-2023

Kochhar, Komal; Soleimani, Leila; Byrne, Bobbi; Stefanidis, Dimitrios; Pettit, Katie; Zakeri, Bitia; Denny, Kim; McNulty, Margaret; Hoffman, Leslie; Brokaw, James; Wallach, Paul

34. Ambiguity, Circularity, and Professionalism in Undergraduate Medical Education

Harris J; Laing J; Olbina A; Lain MC; Cooke NM; Gonzales AE; Perez D; Applegarth IR; Karam M; Turner M; Somayaji M; Schantz EG

35. Developing the Whole Student: Integrating Personal & Professional Development Sessions in Third Year

Heath, Kristen

36. The Importance of Safe "Sensitive Exam" Practice in Preclinical Curriculum

Zuch, Camryn; Schwieterman, Vanessa; Knudson, Laura

37. Disrupted Learning: Student Experiences and Encounters of Humanism in the Anatomy Lab

Anak Ganeng, Brenda; Byram, Jessica; Agosto, Elizabeth

- 38. How are Our Undergraduate Students Doing? Exploring the Emotional Impact of Human Donors in Undergraduate Education**
Shafer, Anna and Dunham, Stacey
- 39. Origins, Storage, and Handling: A Study of Human Skeletal Remains at US Medical Schools**
Woods, Sabrina and Byram, Jessica
- 40. Analysis of Transition to Interprofessional Accredited Continuing Education Activities; 2018 to Present.**
Denny, Kim; Soleimani, Leila; Howenstine, Michelle
- 41. IUSM Continuing Education in Healthcare Professions (CEHP) Specialized Education Framework Utilizes Quality Improvement (QI) Pathway to Create Successful Online Education Program**
Patel, Rima; Bauer, Breann; Lawley, Jeff; Denny, Kim; Howenstine, Michelle
- 42. Challenges Encountered with Interdisciplinary Pediatric Diabetes Education at an Academic Center**
Ray, Lauren and Delecaris, Angela
- 43. Determining the Needs for Pediatric Diabetes Education among Nurses**
Ray, Lauren and Delecaris, Angela
- 44. How Was Your Trip? Implementation and Evaluation of a Post-Return Debrief Curriculum for Trainees Participating in an International Medical Elective**
Patel, Palka and Baenziger, Jenny
- 45. Integrating Longitudinal Community-Based Experiential Learning Across Medical School Classes**
Danner, Ana; Mann, Gary; Syed, Esa; Wilhelm, Erik; Neal, Chemen
- 46. Healthy Body and Healthy Mind Presentations for the Middle School Students Attending Indiana University Northwest Summer Kids College.**
Ndama, Mia; Han, Amy; Kostrominova, Tatiana
- 47. Implementation of a Pediatrics Communication Curriculum for Medical Students**
Leyden, Emily and Meara, Jodie
- 48. Empowering Youth: Examining Health Literacy Gains in High School Students**
Tannir, Shadia; Grischke, Tyra; Bohn, Camden; Hoffman, Leslie
- 49. Patient and Primary Care Provider Language Discordance and Lung Cancer Screening Referrals Among Spanish-Speaking Patients**
Luna Hinojosa, Mariel; Sears, Catherine; Al-Nasrallah, Nawar; Duncan, Francesca
- 50. Perceptions and Barriers to Care for Burmese Refugees, a Multi-Method Qualitative Study**
Nadeem, Manahil and Messmore, Niki
- 51. Development of a Person-Informed Orientation Manual for Kenyan Medical Trainees Rotating in North America**
Baenziger, Jenny; Sirera, Betty; Etling, Mary Ann; Nafiseh, Amira; Slaughter, Mary; White, Grace; McHenry, Megan; Patel, Palka
- 52. Educational Model for Exploring Healthcare Inequities in Hypertension Prevalence and Control**
Richardson, Jennelle; Kline, Hannah; Yeh, Elizabeth
- 53. Teaching Residents Interpretation Best Practices**
Wade, Katherine; Akinduro, Jenifer; Gidia, Nadia; Lawrence, Laura; Banet, Nathan; Scott, Nicole; Johnson, Jasmine; Shanks, Anthony
- 54. Primary Care in Sickle Cell Management (PRISM) Education Program**
Weiner, Benjamin; Saint, Lauren; Jacob, Seethal; Drayton Jackson, Meghan; O'Brien, Andrew
- 55. Health Insurance Types Contribute to Acidosis Risks: A Report from All of Us Cohort**
Gatz, Allison; Xiong, Chenxi; Chen, Yao; Jiang, Shihui; Nguyen, Chi Mai; Li, Xiaochun; Zhang, Pengyue; Eadon, Michael; Su, Jing
- 56. Characteristics Affecting Access to Kidney Transplantation Services in ESRD Network 9 of the Ohio River Valley**
Kelty, Catherine; Drewry, Kelsey; Buford, Jade; Di, Mengyu; Fridell, Jonathan; Sharfuddin, Asif; Adebiyi, Oluwafisayo; Moe, Sharon; Patzer, Rachel

57. Medicine and the Technological Society

Mansoori, Afsheen and Gunderman, Richard

3:00 – 4:00 PM: SCHOLARLY CONCENTRATION POSTER PRESENTATIONS

[2nd Floor Hallway]

1. Medical Students' Perspectives on Transgender Care Legislation and its Impact on Medical Residency Applications.

Kurman, Tari; Ake, Samantha; Hille, Jessica

2. Diversity-Driven Initiatives in a Radiology Residency Program: A Historical Timeline and Analysis of Demographic Changes

Friel, Rylee; Sieck, Leah; Ladd, Lauren

3. Diversity, Equity and Inclusion in Orthopaedics: Improvement through Recruiting Diverse Orthopaedic Applicants

Jones, Jenna; Zheng, Jenny; Malige, Ajith; Talwar, Divya; Wells, Lawrence

4. “I’m supposed to be a helper”: Spiritual Distress of Abortion Providers after Dobbs v. Jackson

Bode, Leah; Kumar, Komal; McQuillan, Josie; Scott, Nicole; Bernard, Caitlin

5. Can a Sex-Positive Sex Education Intervention Reduce Rape-Supportive Attitudes? Formative Research, Pilot Randomized Controlled Trial, and Evaluation of Self-Selection Bias

Peterson, Zoe; Richmond, Kaylee; Holt, Laura; Kimberlin, Robin; Beale, Karen; Cook, Victoria

6. Perceived Barriers among Physicians in Utilization of Mental Health Services - Evaluating the Impact of Rural and Urban Settings

Herman, Ben; Lawson, Katelyn; Danek, Robin; Ireland, Ellen

7. Team-Based Spirituality Concept Analysis

Williams, Anthony; Davis, Justin; George, Evin; Szilagyi, Csaba; Burke, Emily; Akinrinmade, Abimbola; Torke, Alexia; Lion, Alex

8. The Medicalization of Wellness

Yaqub, Amna

9. An Assessment of ChatGPT’s Performance as a Patient Counseling Tool: Exploring the Potential Integration of Large Language Model-based ChatBots into Online Patient Portals

Price, Charles; Brougham, Albert; Burton, Kyle; Dexter, Paul

10. For Watson, Solving Cancer Wasn’t So Elementary: Prospects for Artificial Intelligence in Radiology

Thamba, Aish and Gunderman, Richard

11. Psychiatry Teacher’s Guide: A Web-Based Resource for Faculty Development

Upshaw, Landon; Smith, Alyssa; Giust, Julianne

12. Socioeconomic Disparities in Pain Management after Total Knee Arthroplasty

Alcaide Amador, Doriann; Boyd, LaKeisha; Sotto-Santiago, Sylk

13. Breast Cancer Disparities among Women in Underserved Communities in Northwest Indiana

Al-tarshan, Basem; Patel, Pooja; Han, Amy

14. Do Hispanic Patients Who Require a Medical Interpreter Understand the Nature and Severity of Their Glaucoma Diagnosis?

Bertot, Sophia and Cantor, Louis

15. Health Ratings and Unmet Needs in Indiana’s Home and Community-Based Services Program

Bielski, Margaret and Blackburn, Justin

16. Knowledge and Beliefs of Rural Patients Surrounding Palliative Care

Black, Morgan; Ireland, Ellen; Danek, Robin; Reyes, Eric

17. Examining Interpretation Services for Spanish-Speaking Surgical Patients in an Urban Hospital Setting

Clemens, J Connor; Lentsch, Kristen; Meagher, Ashley

18. Knowledge, Attitudes, and Perceptions of Pharmacogenomics among Low-Income Residents of Central Indiana

Cooper, Joseph and Murthy, Vinaya

19. Social Determinants of Health Associated with Inpatient Admissions for Congestive Heart Failure, Diabetes, Chronic Obstructive Pulmonary Disease, and Asthma

Deckbar, John; DeMichael, Kelly; Gad, Wael; Muvuka, Baraka; Guerrero, Jonathan

20. Socio-Demographic and Behavioral Predictors of Admission for Kidney Disease in an Urban Hospital in Northwest Indiana

DeMichael, Kelly; Deckbar, John; Muvuka, Baraka; Guerrero, Jonathan; Gosporadek, Kyle

21. Drivers of Change: Discussions with Climate Health Leaders

Eigsti, Megan and Holohan, Maggie

22. Identifying Barriers to Nutrition in Indiana

Ertel, Mary Grace; Kruzliakova, Natalie; Witty, Lynn; Mineo, Jocelyn; Holmes, Finch

23. Association of Socio-Demographic Factors, Social Determinants of Health, and Weekly Physical Activity in an Urban Hospital in Northwest Indiana

Gad, Wael; Chandler, Brianna; Jones, Brendan; Mangum, Joshua; Muvuka, Baraka; Guerrero, Jonathan

24. Taking Care of Hispanic and Latino Patients: Training the Future

Garcia, Gloria; Matamoros Santos, Itzel Citlalli; Munguia-Vazquez, Ray; Brosseau-Lapre, Francoise

25. Social Determinants of Health and 30-Day Readmissions in an Urban Community Hospital in Northwest Indiana

Gonsiorowski, Eric; Yallourakis, Michael; Guerrero, Jonathan; Muvuka, Baraka

26. The Effects of the COVID-19 Pandemic Shutdown on Adolescents Enrolled in Indiana Marion County Medicaid from April, 1st 2018-March 31st, 2022 and the Analysis of How Specified Household Factors Affected the Children's Overall Health

Hathoot, Madeline; Andres, Unai; Wiehe, Sarah

27. Exploring Demographic Disparities in Obesity: A Retrospective Observational Study on the Representation of Minority Groups in an Indianapolis Weight Loss Clinic

Hibbard, Jack and Gilmore, Ashley

28. Integrative Review of the Knowledge, Barriers, and Facilitators of HPV Vaccination Among Latinx Migrant and Seasonal Farmworkers in the United States

Hornberger, Sydney and Messmore, Niki

29. Neurovascular Conditions and Associated Socio-Demographic and Behavioral Factors in an Urban Hospital in Northwest Indiana

Jones, Brendan; Chandler, Brianna; DeMichael, Kelly; Muvuka, Baraka; Guerrero, Jonathan; Gosporadek, Kyle

30. Retrospective Analysis of EMS Calls for Opioid Overdose and Geospatial Relationship to Location of Naloxone Access

Bakdash, Manhalh; Harris, Colin; Jones, Cameran; Koczenasz, Jordan; Southard-Goebel, Colton; Southard-Goebel, Anah; Lopilato, Joseph; Witty, Lynn; Fromm, Larry

31. Peripheral Neuropathy in U.S. Long-COVID Patients: Demographic Distribution and Risk Factors

Li, Jason; Bohn, Camden; Todd, Noah; Pater, Jessica; Carroll, Jeanne; Henriksen, Brian; Chang, Fen-Lei

32. Self-Stigma vs. Perceived Public Stigma Toward Mental Illness in Rural Adults

McCreary, Brent; Danek, Robin; Ireland, Ellen; Reyes, Eric

33. Home Gardening and the Barriers We Don't Plant On

Meador, Catherine; Sutton, Maggie; Witty, Lynn

34. Hidden Inequities: Appointment Follow-up Differences in Primary Open Angle Glaucoma Patients

Mulcahey, Caitlyn and Cantor, Louis

35. Analysis of Lung Cancer Disparities in Northwest Indiana

Colston, Kyra; Ndama, Mia; Han, Amy

- 36. A Scoping Review Examining the Interactions of Racial Minorities in the NICU/PICU and their Physicians – Modern Day Jean Beicke**
Pandhiri, Taruni and Mintus, Kenzie
- 37. Discrepancies in Breast Cancer Screening and Staging in Northwest Indiana Impacting Low Income and Black/African American Populations**
Patel, Pooja; Altarshan, Basem; Han, Amy
- 38. Implementation of RedCap Data Systems in Kenyan Psychiatric Rehabilitation: A Community Case Study**
Patel, Neal and Turissini, Matthew
- 39. Change in Medical Students' Attitudes towards Family Planning after Pregnancy Counseling Panel Intervention**
Peipert, Leah; Brown, Lucy; King, Carli; Bhamidipalli, Surya Sruthi; Stout, Julianne; Peipert, Jeffrey; Caldwell, Amy
- 40. Understanding Diabetes Care in an Urban Setting: A Student-Led Free Clinic's Impact**
Prabhakar M and Sevilla J
- 41. Healthcare Experiences of Formerly Incarcerated People in Indiana**
McCartney, Rebecca
- 42. The Influence of Relationships and Social Media on AYA Cancer Survivor Wellness**
Rodriguez, Samantha; Hartsock, Jane; Beckman, Emily
- 43. Increased Depression and Anxiety among Remote Workers during the COVID-19 Pandemic: A Longitudinal Cohort Study in Southwest Indiana**
Rone, Victoria and Garcia, Kara
- 44. Retrospective Analysis of COVID-19 Impact on Social + Emotional Development in Children of Low-Income Communities from Head Start**
Li, Gabrielle; Sanapati, Satya; Han, Amy
- 46. How COVID-19 Impacted Community Health Coalition Functioning and Strategies Used to Adapt**
Vandeventer, Luke and Savaiano, Dennis
- 45. Latinas' Perspectives on Donating Healthy Breast Tissue: Implications for Recruitment Methods and Messaging**
Vogel, Katherine and Ridley-Merriweather, Katherine
- 47. Advanced Visual Analytics in Support of Data-Driven Opioid Addiction Prevention and Treatment**
Qaurooni, Danial; Herr II, Bruce; Zappone, Sarah Renee; Wojciechowska, Klaudia; Börner, Katy; Schleyer, Titus
- 48. The Impact of Hospital-Based School Programs on Rural versus Urban Students**
Wright, Madelynne; Curtin, Michelle; Ormiston, Heather; Reisinger, Debra; Reyes, Eric; Wikel, Kristin; Husmann, Polly
- 49. Identifying Socio-Demographic and Behavioral Predictors of Prolonged Hospital Stay in an Urban Hospital in Northwest Indiana**
Yallourakis, Michael; Gonsiorowski, Eric; Muvuka, Baraka; Guerrero, Jonathan
- 50. Assessing Interest Among Providers and Learners in Education on the Environmental Impacts of Anesthesia**
Sizemore, Brandon; San Roman II, Gabriel; Boyer, Tanna
- 51. The Association of ADRA2A Genotype with Dexmedetomidine Dosage in Pediatric Patients**
Biju, Ashwin; Gallaway, Katherine; Skaar, Todd; Tillman, Emma
- 52. Undiagnosed Rare Disease Clinic Identifies a Novel UBE3A Variant in Two Sisters with Angelman Syndrome: The End of a Diagnostic Odyssey**
Bruns, Rebecca; Liaqat, Khurram; Nasir, Abdul; Treat, Kayla; Murthy, Vinaya; Mantcheva Lili Torres, Wilfredo; Conboy, Erin; Vetrini, Francesco
- 53. Non-Invasive Quantification of Murine Myocardial Infarct Size through Ultrasound**
Clark, Sydney; Dann, Melissa; Trzaskalski, Natasha; Earl, Conner; Schepers, Luke; Pulente, Serena; Lennord, Ebonee; Annamalai, Karthik; Gruber, Joseph; Cox, Abigail; Lorenzen-Schmidt, Ilka; Seymour, Richard; Kim, Kyoung-Han; Goergen, Craig; Mulvihill, Erin

54. The Effect of Large Femoral Heads and Acetabular Cup Position on PROMs after Modern Posterior Approach THA

Darden, Austin; Deckard, Evan; Meneghini, R. Michael

55. Applying Cyclical Loading Parameters for In-Vitro Neo-Tendon Development

Darden, Kylee; Jenkins, Thomas; Pourdeyhimi, Behnam; Little, Dianne

56. Spiritual and Avoidant Coping among a Cohort of Breast Cancer Survivors Receiving Acceptance and Commitment Therapy

Devanathan, Nirupama; Johns, Shelley; Slaven, James; Axel-Adams, Robyn; Lion, Alex

57. HLA-E and HLA-G Co-expression in Porcine Endothelial Cells Attenuate Human NK Cells Degranulation

Farag, Kristine; Cross-Najafi, Arthur; Wilmes, Danielle; Zhang, Wenjun; Li, Ping; Ekser, Burcin

58. Characterization of a Novel Mutation in the COPI Vesicle on Binding to Dilysine Motifs

Felipe, Kimberly; Custer, Sara; Androphy, Elliot

59. Cholestasis in the First Trimester Associated with Rare ABCG5/8 Variants: A Case Study

Ganapaneni, Sruthi; Winston, Blessed; Dhas, Arul; Vuppalanchi, Raj; Quinney, Sara

60. Fabrication of an Electrically Conductive Adhesive for Skin Mounted Bioelectronic Devices

Gong, Sunland; Kim, Min Ku; Chang, Tae Hoo; Lee, Chi Hwan

61. Death and Dramatic Spaces in "Old Mrs. Harris" and the "Death of Ivan Ilyich"

Hodges, Matthew and Prenatt, Diane

62. Assembly of the Drosophila Melanogaster Mitochondrial Reference Genome using Fifty-Five Strains Collected from Diverse Global Locations

Kabangu, Mirindi; Gillespie, Patrick; Fischer, Adam; Lancaster, Makayla; Todd, Dylan; Graham, Brett

63. Optimizing Transport Methods to Preserve Function of Self-Innervating Muscle Cells

Kaefer, Samuel; Zhang, Lujuan; Brookes, Sarah; Morrison, Rachel; Voytik-Harbin, Sherry; Halum, Stacey

64. Successful Sperm Retrieval in a Male with Azoospermia, Partial Azfa Deletion, and CFTR Mutation: A Case Report and Literature Review

Crist, Nikos; Karcher, Christian; Bernie, Helen

65. Fixed Lateral Uni-compartmental Knee Replacement is a Reliable Treatment for Lateral Compartment Osteoarthritis after Mobile-Bearing Medial Uni-compartmental Replacement

Lazzara, Joseph; Arthur, Lachlan; Jenkins, Cathy; Dodd, Christopher; Mellon, Stephen; Murray, David

66. Understanding the Human Condition Through Degas and His Bronzes

Martin, Daniel; Beckman, Emily; Hartsock, Jane

67. TMPRSS3 Deficiency Does Not Affect Auditory Neuron Differentiation: Implications for Cochlear Implantation

Moawad, Jasmine; Chen, Jeffery; Cabrera, Ernesto; Nelson, Rick

68. The Ineffectiveness of HPV L1 Vaccines as a Therapeutic Vaccine against HPV 16/18 and Associated Diseases

Morris, Folami and Androphy, Elliot

69. Exploring Parents' Experiences While Viewing MRI images at a Fetal Center

Salih, Zeynep; Brown, Brandon; Tullar, Rachel; Martin, Louis; O'Connor, Nicholas

70. Immunoreactive Trypsinogen Levels in Infants Born to Women with Cystic Fibrosis Taking Elexacaftor-Tezacaftor-Ivacaftor

Patel, Payal; Yeley, Jana; Brown, Cynthia; Wesson, Melissa; Lesko, Barbara; Slaven, James; Chmiel, James; Jain, Raksha; Sanders, Don

71. Voices in Care: A Comprehensive Analysis of Nurse Perceptions of the Indiana State Nurses Association

Ebeyer, Matthias; Natalie, Austin; Patel, Bhumi

72. Retrospective Cohort Analysis of Colorectal Cancer Staging in Northwest Indiana

Peterson, Luke; Zhang, William; Han, Amy

73. Detection of Parkinsonian Motor Symptoms Using Non-Invasive Motion Sensing Technology

Sakaleros, John; Shamloo, Farzin; Shanghai, Aditya; Sereno, Anne

74. Patient Satisfaction with Teleneurology across Neurologic Conditions

Seigel, Courtney; Martin, Holly; Bastin, Grace; Myers, Laura; Taylor, Stan; Pike, Francis; Wilkinson, Jayne; Williams, Linda

75. Exploring a Transcriptome-forward Approach for Genetic Evaluation in Thoracic Aortopathy

Stanley, Katherine and Landis, Benjamin

76. Management of Venous-occlusive Disease and Severe Thrombocytopenia Following Allogeneic Hematopoietic Cell Transplant in a Patient with JMML

Suescum, Camilo; Blazin, Lindsay; Rahrig, April

77. Enhancing Financial Sustainability in Psychiatry Services: Exploring a Cash-Based Model

Thomson, Joshua; Harrington, Marsa Ann; Hulvershorn, Leslie

78. Effect of Delayed Thrombectomy on Functional Outcomes After Ischemic Stroke

Todd, Noah and Chang, Fen-Lei

79. Parents' Perspectives of Decisional Authority in Periviable Delivery Decision-Making

Cheng, Erika; Schultz, Victoria; Castellon-Perez, Naomi; Hoffman, Shelley; Witting, Hannah; Tucker Edmonds, Brownsyne

80. The Contribution of Genetic Risk for Alzheimer's & Cardiovascular Disease to Recovery from Traumatic Brain Injuries

Wood, Ethan and Nudelman, Kelly

4:00 – 5:00 PM: RECEPTION & CERTIFICATES

[Auditorium Lobby]

Presented by Paul Wallach, MD

REVIEWERS

1. Elizabeth Agosto
2. Margaret Bauer
3. Margaret Beliveau-Ficalora
4. Amanda Benaderet
5. Charline Boente
6. Tanna Boyer
7. James Brokaw
8. Jessica Byram
9. Bobbi Byrne
10. Jennifer Choi
11. Jason Collett
12. Christine Eckel
13. Polly Husmann
14. Leslie Hoffman
15. Ann Jones
16. Kathy Jones
17. Samar Khirallah
18. Judith Maddatu
19. Joshua Mangum
20. Margaret McNulty
21. Rakesh Mehta
22. Sally Mitchell
23. April Newton
24. Valerie O'Loughlin
25. Vivian Ott
26. Katie Pettit
27. Jennelle Richardson
28. Kyle Robertson
29. David Rodgers
30. Matt Ritter
31. Elizabeth Ryan
32. Anthony Shanks
33. Adrian Singson
34. Sacha Sharp
35. Sabrina Silver
36. Sylk Sotto
37. Katie Stanton
38. Dimitris Stefanidis
39. Matthew Tews
40. Corinna Yu

PLANNING COMMITTEE

Komal Kochhar, MBBS, MHA (Chair)

Leslie Hoffman, PhD

Margaret McNulty, PhD

Dimitrios Stefanidis, MD, PhD

Paul Wallach, MD

ACKNOWLEDGEMENTS

Continuing Education in Healthcare Professions (CEHP): Leila Amir Soleimani and CEHP Team

Educational Affairs Data Analytics (EDA): Maddie Potter

Research in Medical Education (RIME): Monling Ho

Continuing Medical Education Learner Information

Course Objectives:

- Identify examples of best practices in medical education
- Recognize the current approaches to assessing and evaluating learners
- Describe how educational outcomes data can be presented and published
- Network and collaborate with educators from other IUSM departments and campuses

Accreditation Statement



In support of improving patient care, Indiana University School of Medicine is jointly accredited by the Accreditation Council for Continuing Medical Education (ACCME), the Accreditation Council for Pharmacy Education (ACPE), and the American Nurses Credentialing Center (ANCC), to provide continuing education for the healthcare team.

Physicians

Indiana University School of Medicine designates this live activity for a maximum of 5.5 *AMA PRA Category 1 Credits™*. Physicians should claim only the credit commensurate with the extent of their participation in the activity.

University Tower

FIRST FLOOR

Hine Hall

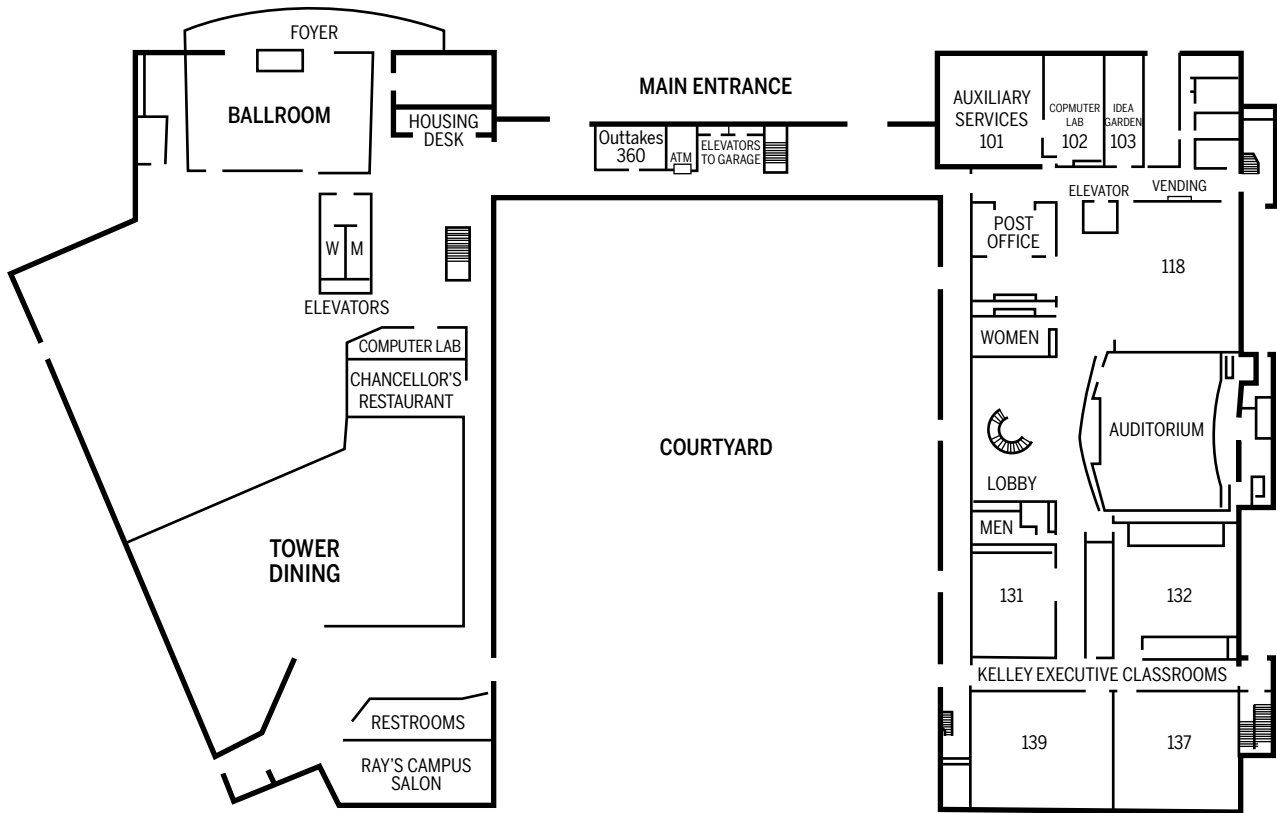

University Tower

SECOND FLOOR

Hine Hall

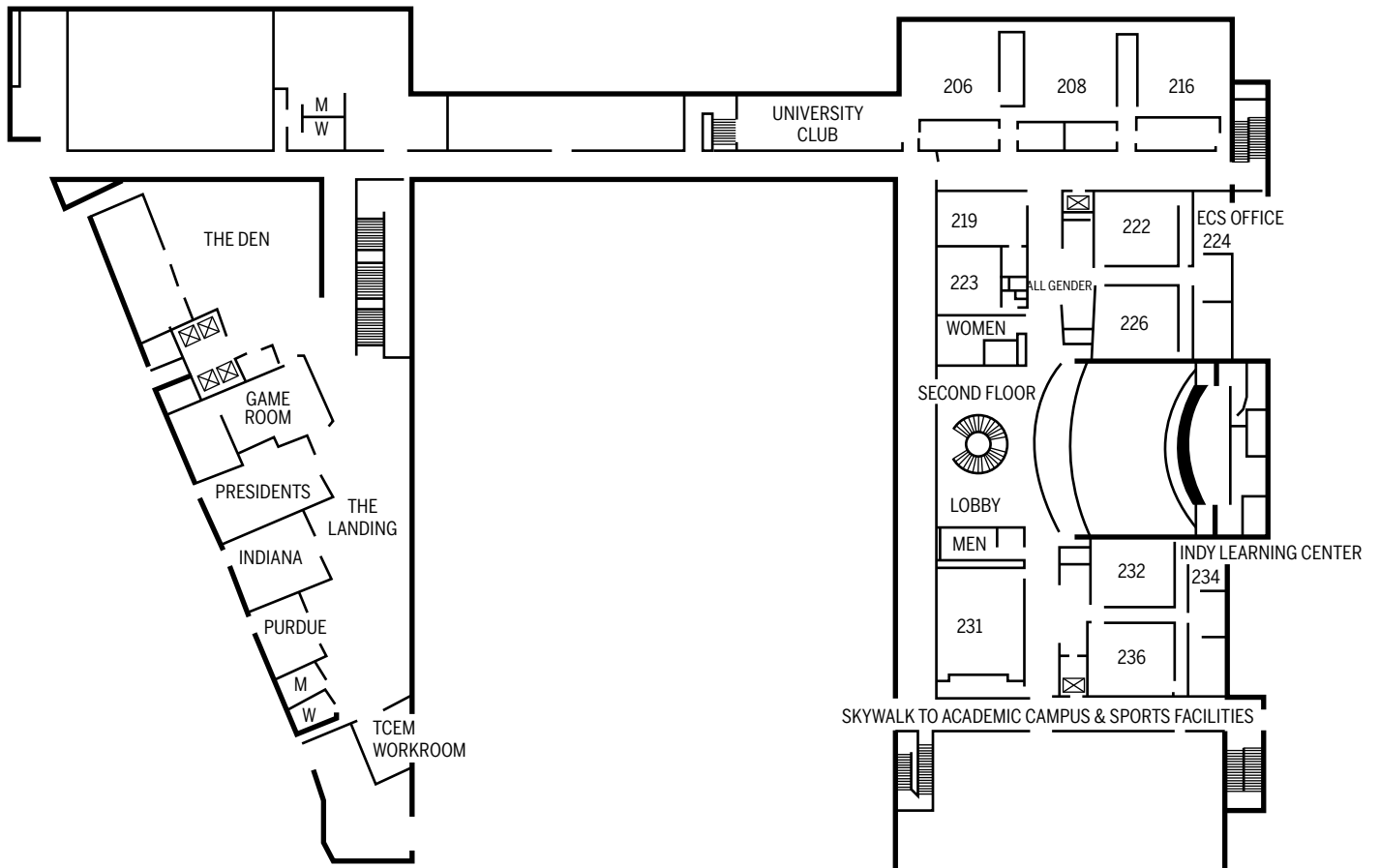

Follow us on 

#IUSMEdDay2024



INDIANA UNIVERSITY
SCHOOL OF MEDICINE